

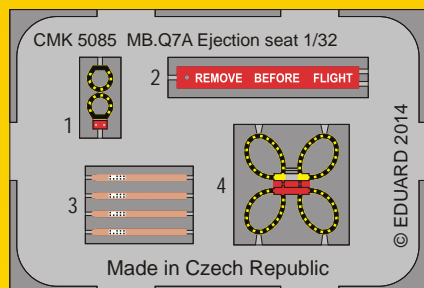

NEWS

03/2014

MPM Production Ltd., Mezilesí 718, 193 00, Praha 9, Czech Republic
tel.: +420 281 923 909 fax: +420 281 923 910 e-mail: cmk@mpm.cz
official website and e-shop: www. cmkkits.com



ITEM
5085

MB.GQ-7A Ejection seat (European F-104G)
for Has./Rev./Ita.kit

Scale
1/32

Set contains completely new Martin Baker MB.GQ-7A ejection seat used in F-104G airplanes of European AF (Germany, Italy...). This set contains coloured photo etches.

Germany, Italy / Modern

B.C. 8595593120836

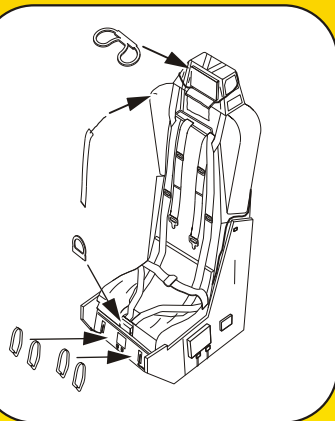

ITEM
7280

Typhoon Mk.I
– Control surfaces set for Airfix kit

Scale
1/72

This detailed set contains landing flaps and new tail planes with separated elevators that can be attached in up or down position. The British WW2 fighter made itself famous in the interceptor role against German fighter-bombers and is known also for anti-ground attacks in occupied France.

GB/WWII

B.C. 8595593120843

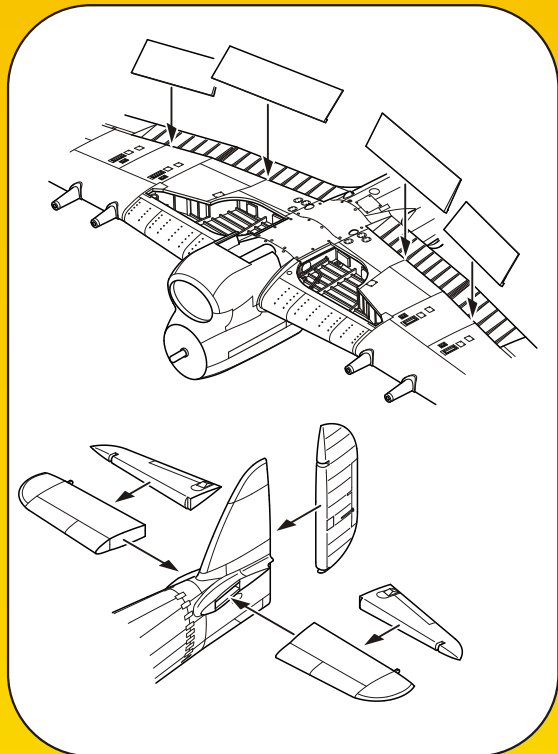

ITEM
7283

A6M5 Zero
– Engine set for Tamiya kit

Scale
1/72

Set contains complete Nakajima Sakae 21 engine installation for late version of the most famous Japanese naval fighter plane of the Second World War. The open engine compartment installation consists of detailed cast resin engine, engine bulkhead, bearers, exhausts and appropriate covers. Contains also coloured photo etches.

Japan/WWII

B.C. 8595593120850

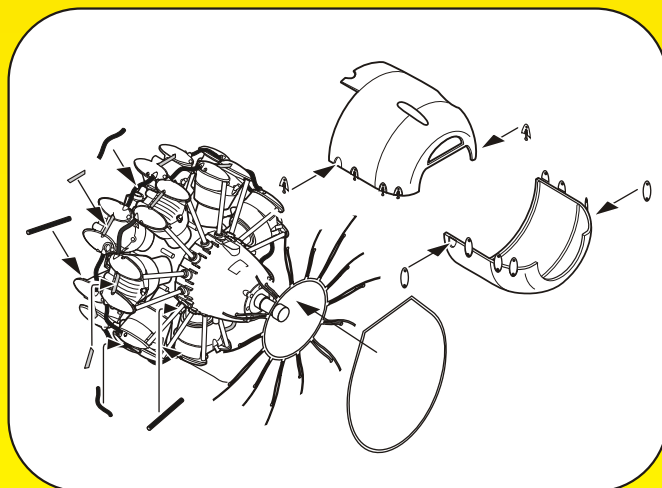
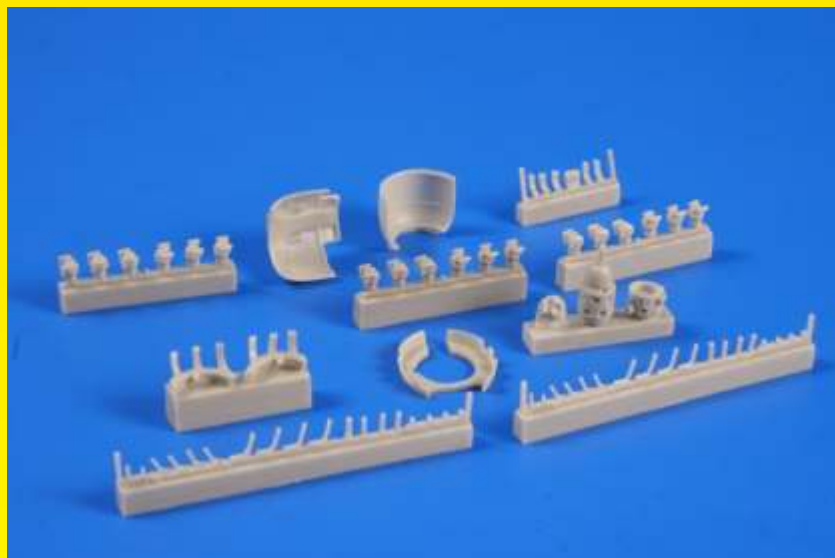
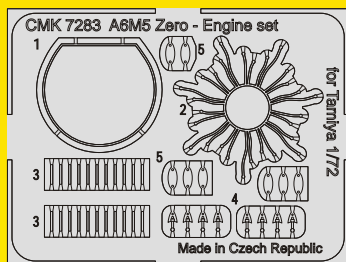

ITEM
7284

A6M5 Zero
– Control surfaces set for Tamiya kit

Scale
1/72

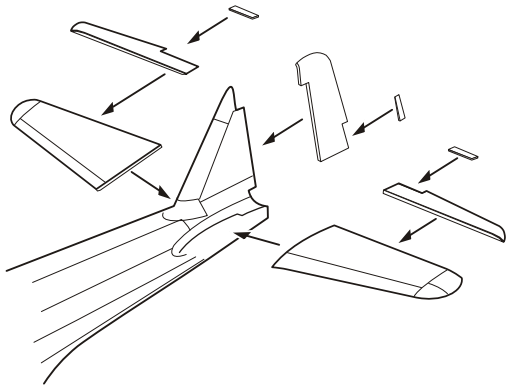

Detailed set with landing flaps and new tail planes for late version of the most famous Japanese naval fighter plane of the Second World War. The tail planes have the control surfaces separated and these can be attached in deflected position. The trim tabs are also separated.
Japan / WWII

B.C. 8595593120867

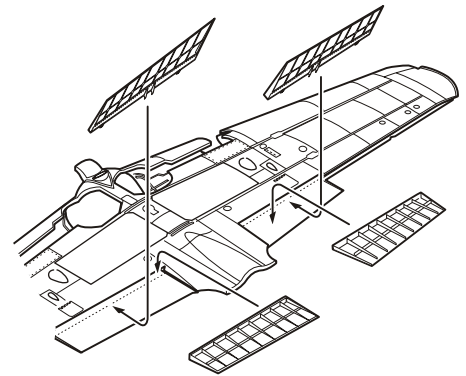

ITEM
7286

A6M5 Zero
– Exterior set for Tamiya kit

Scale
1/72

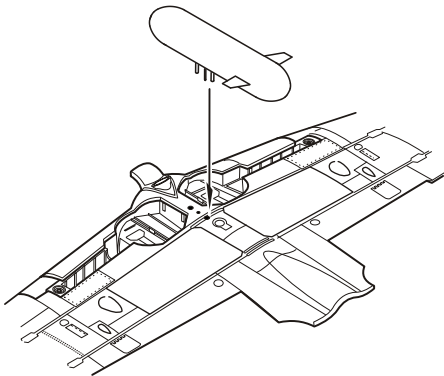

Detailed set enabling to expose the tailwheel mechanism, to attach the rudder in deflected position and assembly the model with the ventral auxiliary tank. The set contains detachable rear part of the fuselage, new tailwheel leg attachment, tailwheel, bulkhead, new rudder with separated trim tab, wheel chocks and new ventral auxiliary fuel tank of different type for the most famous Japanese naval fighter plane of the Second World War.
Japan / WWII

B.C. 8595593120874

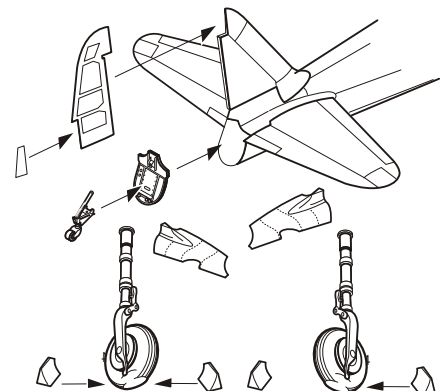

ITEM
7287

**Avro Lancaster Mk.I/III
– Interior set for Airfix kit**

Scale
1/72

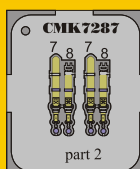
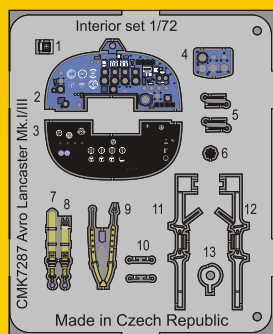

Detailed set with new cockpit floor, seats, radio set, rudder pedal assembly, control column, instrument panel and other parts. Avro Lancaster was wide-spread four-engine WW2 RAF bomber. The set contains colour photo etches.
GB / WWII

B.C. 8595593120881

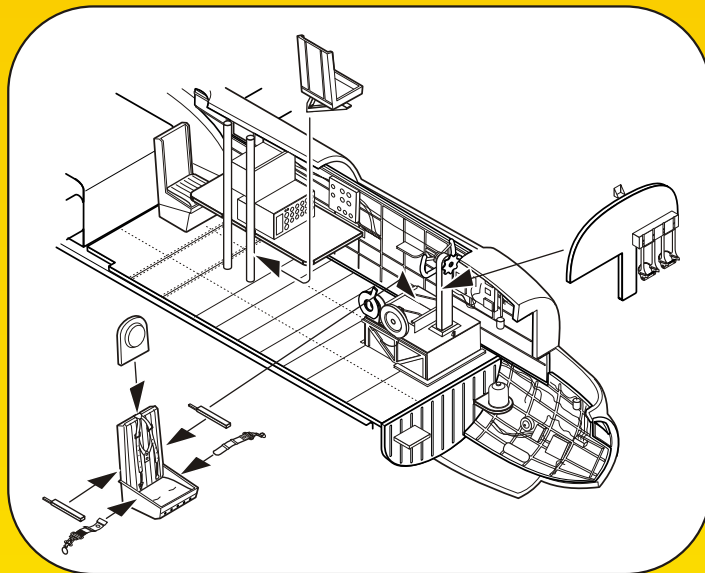
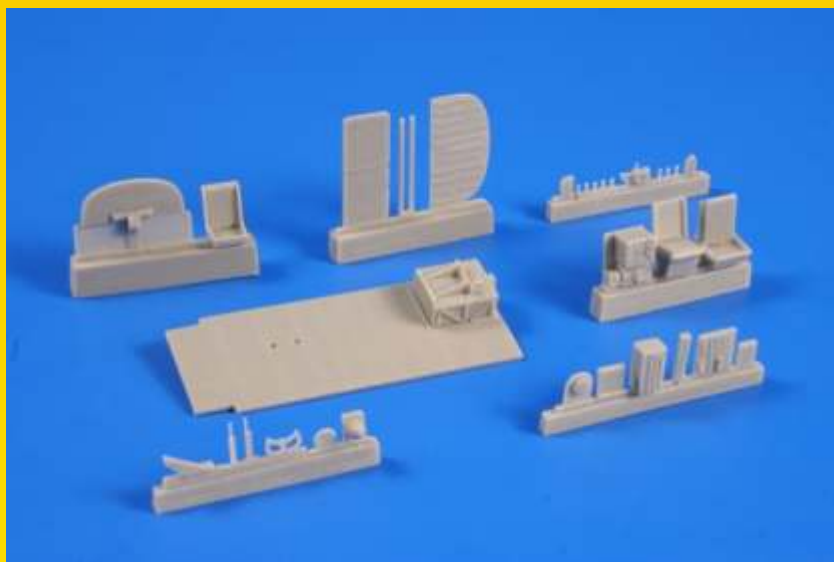

ITEM
7288

**Avro Lancaster Mk.I/III
– Engine set for Airfix kit**

Scale
1/72

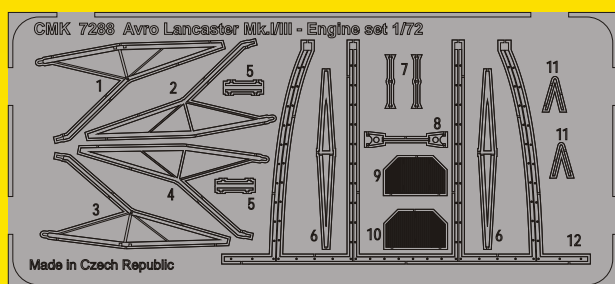

Detailed set containing port inner engine installation with the cowlings, bearers, exhausts, engine bulkhead and the radiators. Avro Lancaster was wide-spread four-engine WW2 RAF bomber. The set contains colour photo etches.
GB / WWII

B.C. 8595593120898

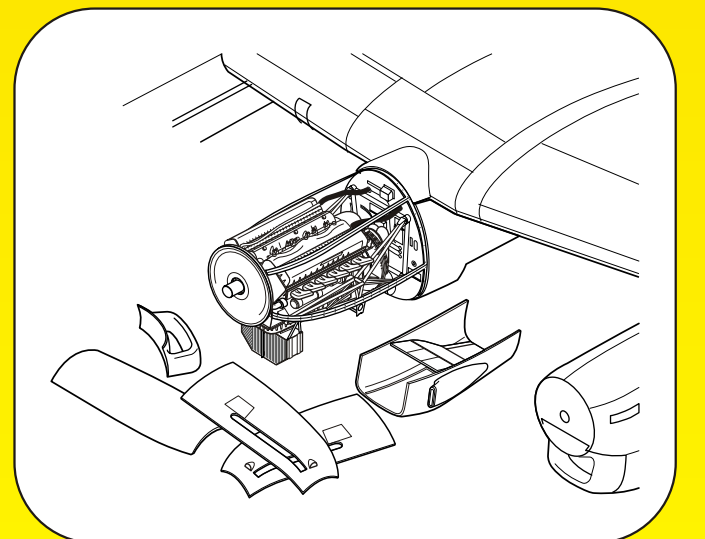

ITEM
MV 112

Multi Water Tank Container, 10 m³ – full resin kit

Scale
1/72

Full resin kit of 10 cubic meter drinking water container that is being used in military and humanitarian missions in Europe or Afghanistan. The front, roof, top frame with walk-sheets and control box are to be attached to the tank. The set contains decal sheet.

Germany / Modern

B.C. 8595593120904

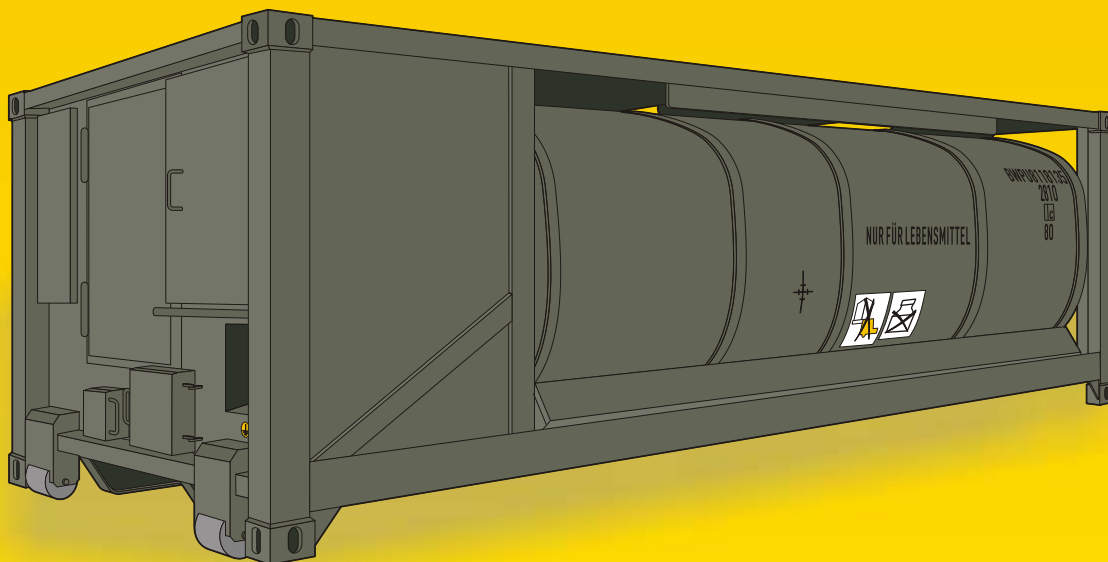

15 BWPU 011 893 2810	12 BWPU 011 893 2810	13 BWPU 011 900 2810	14 BWPU 012 719 2810
16 BWPU 011 900 2810	12 BWPU 011 893 2810	13 BWPU 011 900 2810	14 BWPU 012 719 2810
17 BWPU 012 719 2810	12 BWPU 011 893 2810	13 BWPU 011 900 2810	14 BWPU 012 719 2810



ITEM
PLT261

C-450 Coléoptère full resin kit

Scale
1/72

Full resin kit of prototype of French jet VTOL plane with annular wing.

The model consists of resin parts, vacuum formed clear parts, white-metal u/c legs and decals.

France / post WWII

B.C. 8595593120911

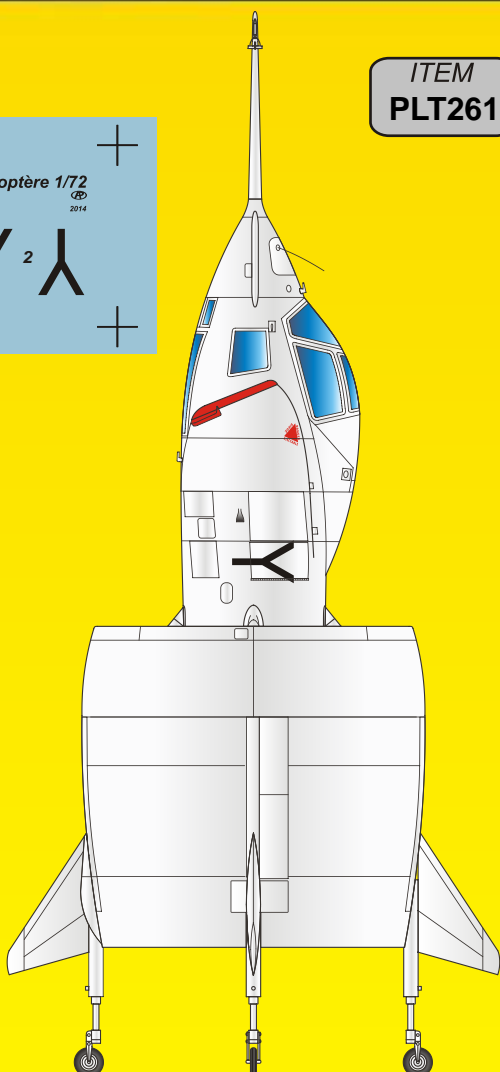
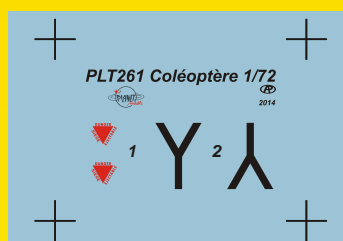

Set contains completely new and highly detailed exhausts. Seafire Mk.47 was post-war version of British carrier fighter plane and saw action over Korea.

GB / post WWII and Korean War

B.C. 8595593120928

