



# NEWS

# 01/2014

MPM Production, Mezilesí 718, 193 00, Praha 9, Czech Republic  
tel.: +420 281 923 909 fax: +420 281 923 910 e-mail: cmk@mpm.cz  
official website and e-shop: www. cmkkits.com

ITEM  
7269

## Fairey Swordfish – Engine set for Airfix kit

Scale  
1/72



Set contains highly detailed engine with compartment for the legendary British carrier borne torpedo bomber. It contains Pegasus IIIM engine including particular cowl plates, exhaust and suction tubes and photo-etched parts.

**GB / WWII**



ITEM  
7270

## Fairey Swordfish – Interior set for Airfix kit

Scale  
1/72

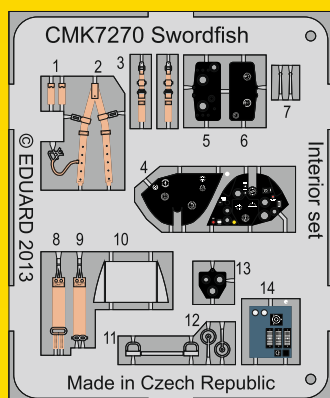

Set contains highly detailed interior for the legendary British carrier borne torpedo bomber that also operated from land bases. It contains new floor, side walls, seats, both horizontal and vertical bulkheads, control stick and instrument panel and colored photo-etched parts.

**GB / WWII**



ITEM  
7271

### F-86F Sabre – Undercarriage bays for Airfix kit

Scale  
1/72

Set contains new deeper and highly detailed wheel wells including particular doors. F-86s Sabre gain its fame during Korean War deployment.  
**USA / post WWII - Korean War**

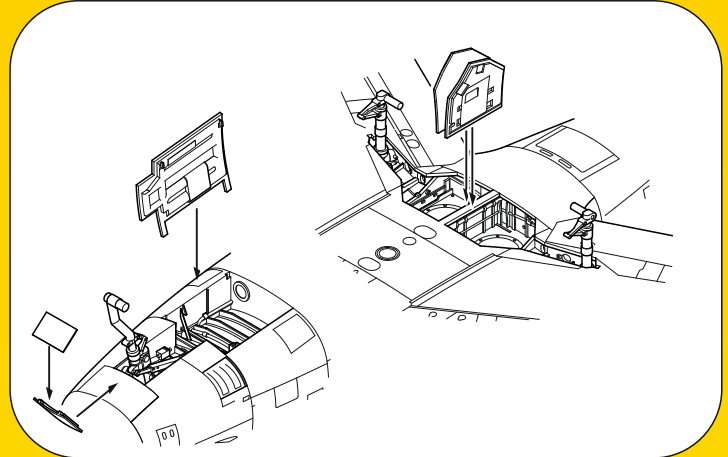

ITEM  
7272

### F-86F Sabre – Exterior set for Airfix kit

Scale  
1/72

Set contains highly detailed exterior parts, including speed brakes with particular bays, actuator rods, both fuselage sides' ammunition magazines with particular doors. F-86s Sabre gain its fame during Korean War deployment.  
**USA / post WWII - Korean War**

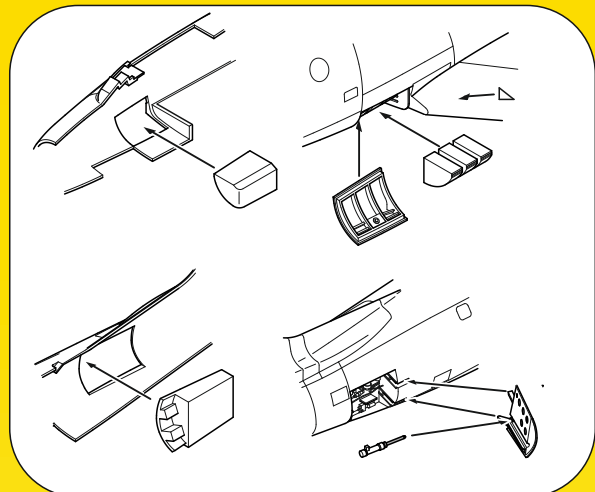
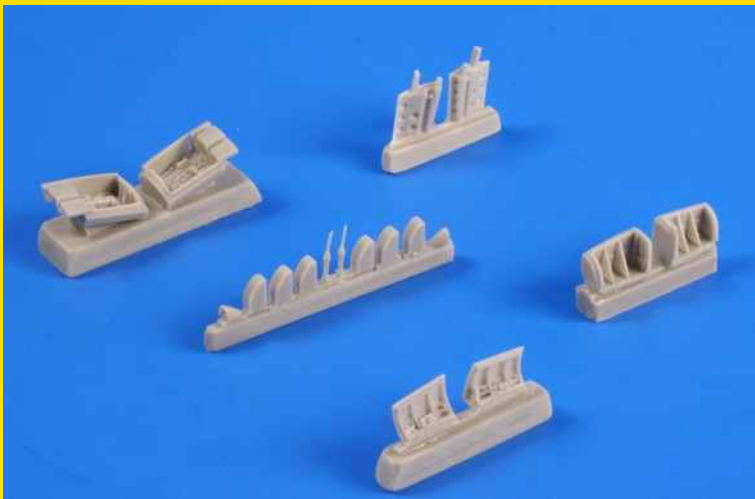

ITEM  
7274

## Seafire FR. 47 – Engine set for Special Hobby kit

Scale  
**1/72**

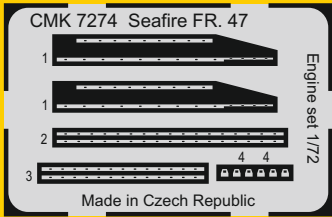

Set contains highly detailed engine with compartment. It contains Griffon 80 series engine with its bed and bulkhead, oil tank and particular cover plates. Seafire Mk.47 was a post war version of the British carrier borne aircraft that was deployed during Korean War. Set contains photo-etched parts.

## GB / post WWII - Korean War



ITEM  
7276

## Bf 109G-6 – Interior set for Airfix kit

Scale  
**1/72**

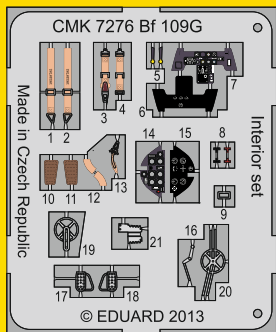

Set contains highly detailed interior for the legendary German fighter aircraft. It contains new floor, side walls, bulkheads, control stick, rudder pedals, instrument panel and other bits from colored photo-etched parts. The set is designed for new Airfix kit.

## Germany / WWII



ITEM  
7277

## Typhoon Mk.I Bubble Canopy – Interior set for Airfix kit

Scale  
1/72

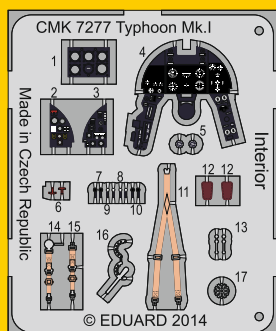

Set contains highly detailed interior for the legendary British fighter aircraft. It contains new floor, side walls, bulkheads, control stick, rudder pedals, instrument panel and other bits from colored photo-etched parts. The set is designed for new Airfix kit.

**GB / WWII**

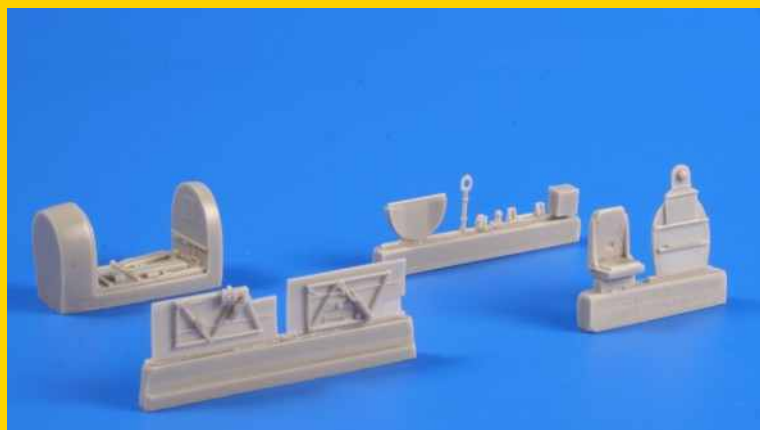

ITEM  
Q48192

## Seafire FR.47 – Seat with harness for Airfix kit

Scale  
1/48

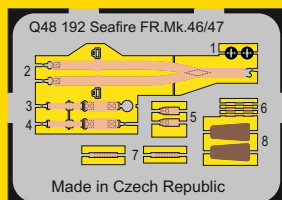

Highly detailed resin cast seat and armour plate behind it. The seat harness is provided from colour Photo-etched parts. Seafire Mk.47 was a post war version of the British carrier borne aircraft that was deployed during Korean War. Set contains colored photo-etched parts.

**GB / post WWII - Korean War**

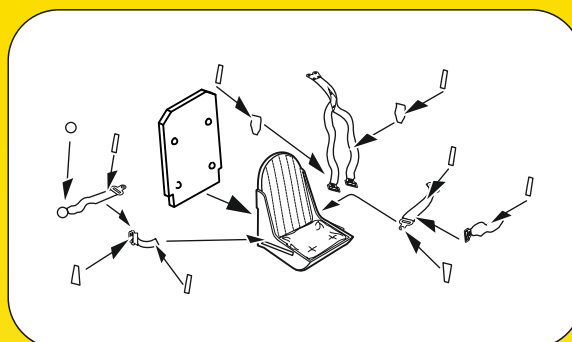

ITEM  
Q48 194

### MiG-29SMP/BM Fixed IFR Probe

Scale  
1/48

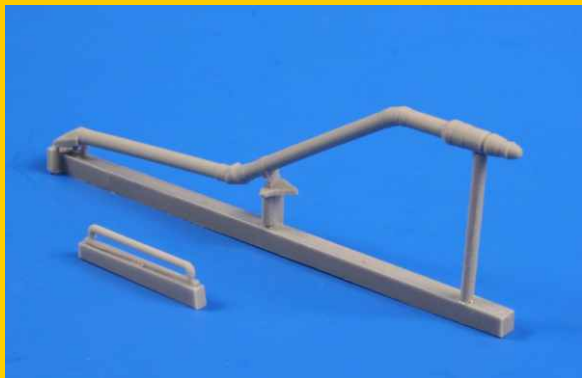

Fixed in-flight refuelling probe used on modernized MiG-29SMPs of the Peruvian Air Force and MiG-29BMs of the Russian and Belarusian Air Forces. The master was designed using the 3D software and in cooperation with Peruvian Antarki company. One of the Peruvian MiG-29s were very carefully measured to achieve exact dimensions for this resin set.

**Russia, Belarus, Peru / Modern...**

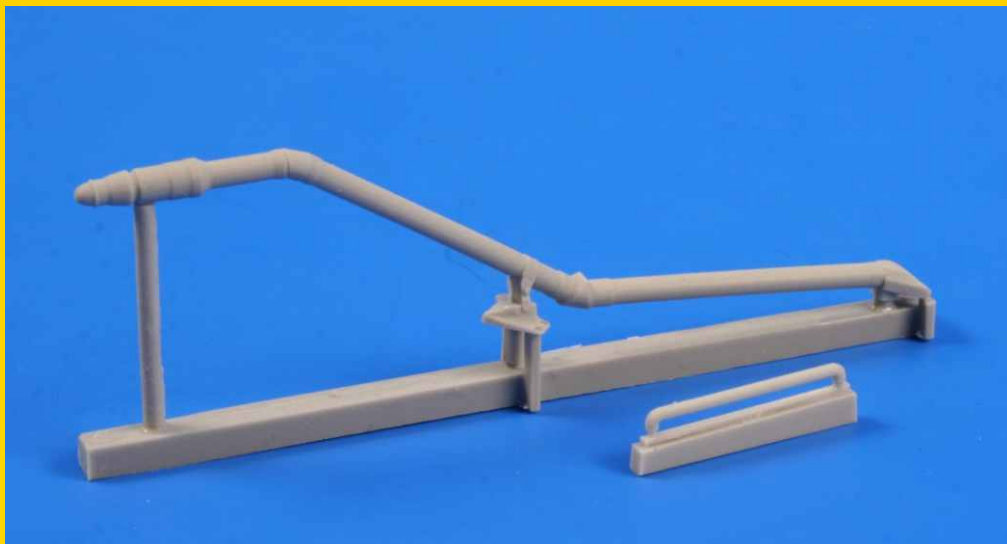

ITEM  
Q48 195

### F-4B/N Phantom II – Wheels for Hasegawa kit

Scale  
1/48

Set contains highly detailed wheels with early type of discs for naval version of F-B/N Phantom II.

**USA / Modern**



Set contains highly detailed wheels with late type of discs for naval version of F-J/S Phantom II.  
**USA / Modern**



Correction set designed to fit the new Hurricane Mk.I with fabric wing kit. The kit offers four spoke wheel discs. But all Hurricane with fabric wing, both RAF and exported machines were equipped with five spoke wheel discs. You can easily fix this drawback with our highly detailed with five spoke wheels.

**GB / WWII**

