



NEWS

07-08/2013

CMK, Mezilesí 718, 193 00, Praha 9, Czech Republic
tel.: +420 281 923 909 fax: +420 281 923 910 e-mail: cmk@mpm.cz
official website and e-shop: www. cmkkits.com

ITEM
5081

Heinkel He 219A Armament set for Revell kit

Scale
1/32

Set contains highly detailed wing roots' armament bays with MG 151/20 cannons and particular covers. He 219 was modern German twin-engined night fighter deployed by Luftwaffe at the end of WW II against the allied bombers.
Germany, WWII

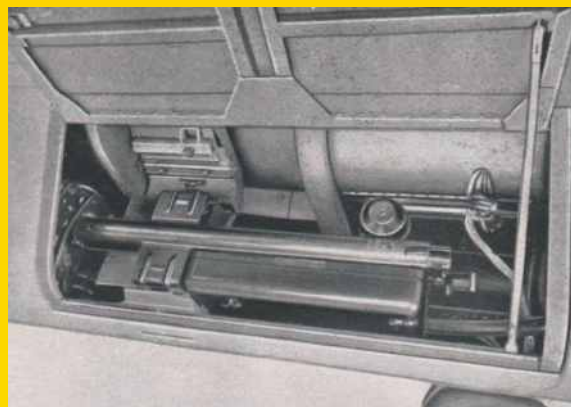
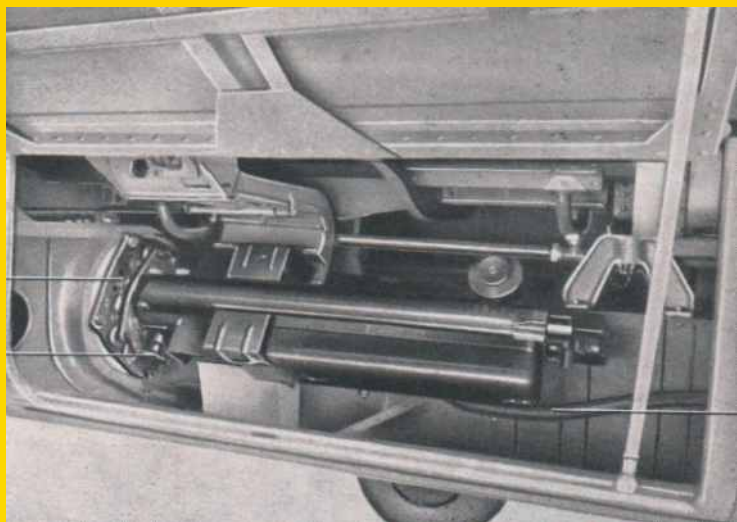

ITEM
5082

Heinkel He 219A Engine set for Revell kit

Scale
1/32

Set contains completely new DB 603 engine and its bed, bulkheads and particular covers.
Germany, WWII

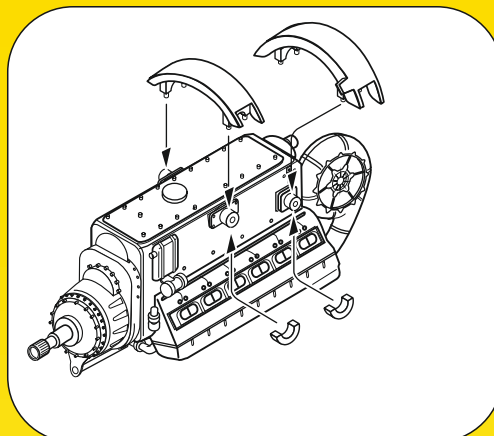
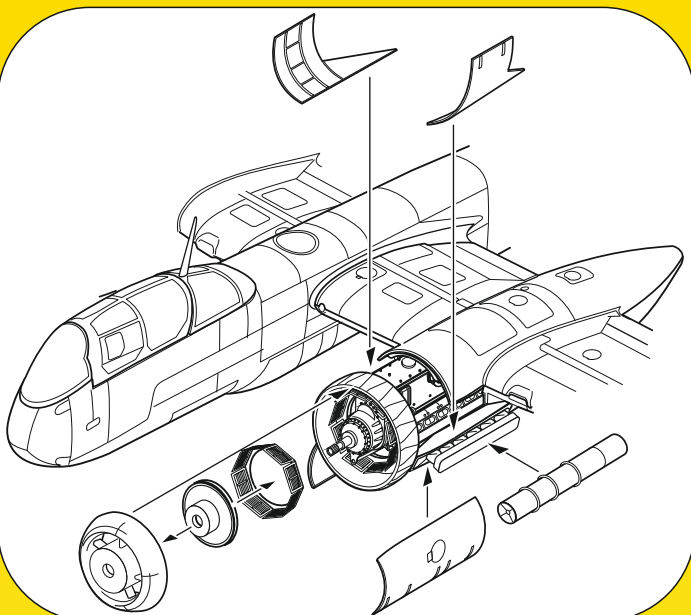

Detailed resin model of very unorthodox US Navy fighter prototype. Designed during World War 2, but advent of the jet engines era prevented it from further trials.

The model contains detailed resin parts, white metal cast undercarriage legs, vacuformed canopy and nose section and decals.
USA, WWII

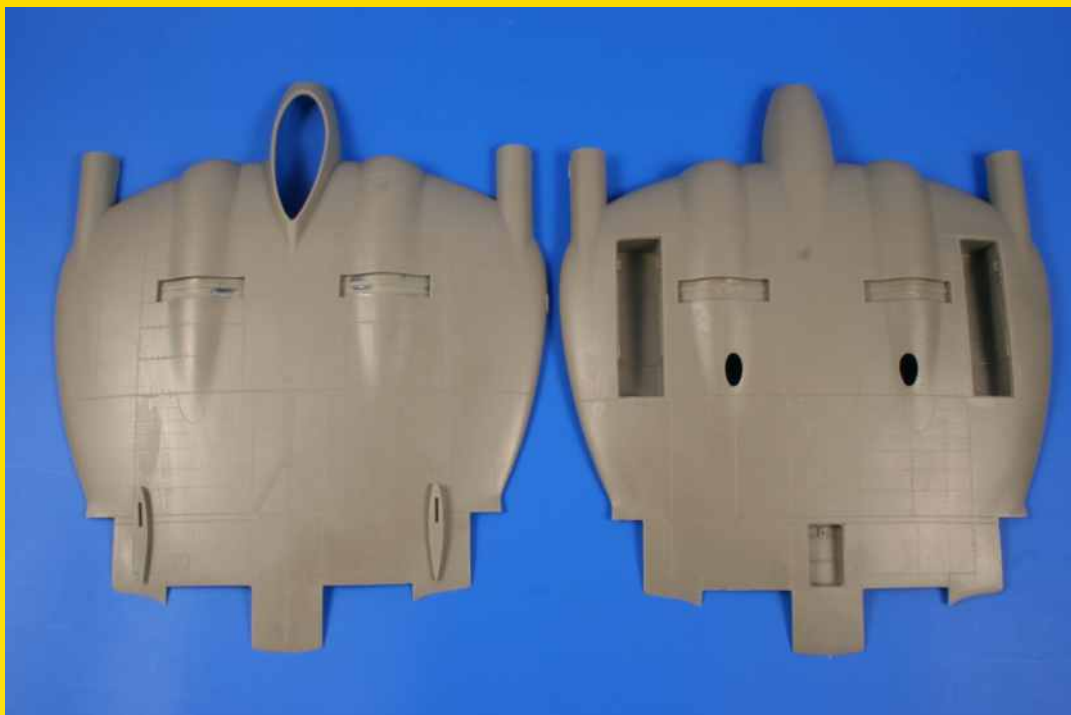

ITEM
F35 242

Cuban Leader

Scale
1/35

Highly detailed figure represents left-wing revolutionary and long-time Cuban president Fidel Castro in his military uniform.

Cuba, Modern



ITEM
F35 243

Che Guevara

Scale
1/35

Highly detailed figure represents radical Argentine Marxist revolutionary mainly known for his acting in Guatemala, Mexico, Cuba, Zaire and Bolivia.

Argentina, Cuba, Modern



4268 MD-500E/OH-6DA - Conversion Set 1/48



ITEM
4268

MD-500E/OH-6DA- Conversion set for Academy kit

Scale
1/48

Set contains completely new cockpit (floor, instrument panel, seats, bulkheads, controls...), tail boom, wire cutters and new, clear canopy that allow conversion from MD-500 to MD-500E / OH-6DA with specific picked nose. Set also contains colour photo-etched parts and huge decal sheet. Decal offer markings for 2 Finnish Army machines and 6 Japanese Self Defence Navy machines.
Japan, Finnish, Modern

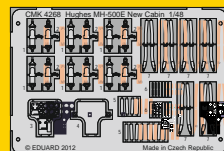

ITEM
4297

Seafire Mk.46/47 – Control surfaces set for Airfix kit

Scale
1/48

Set contains new control surfaces for Airfix kit. The ailerons, rudder, elevators and stabilizers for British post-war carrier fighter aircraft. All the parts feature fine surface details – engraved panel lines and covers and rivets – the details the original kit lacks.

GB, post WWII/Korean War

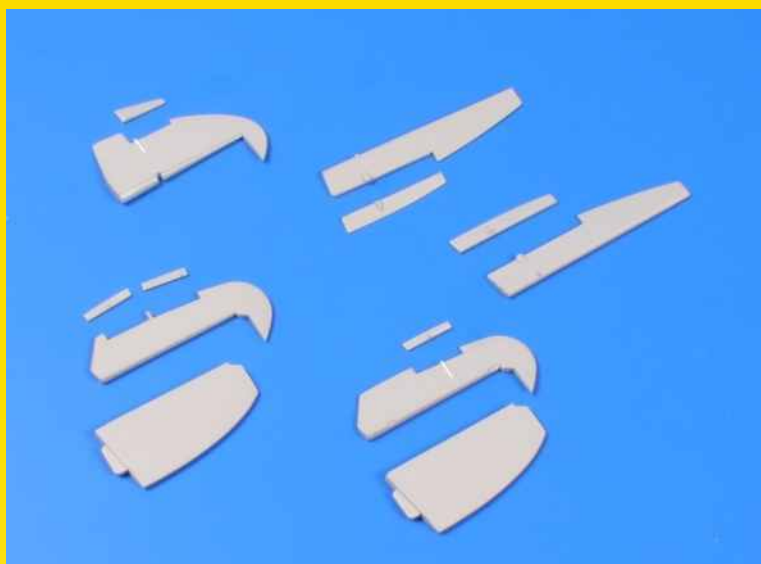

ITEM
4298

**Seafire Mk.46/47 – Interior set
for Airfix kit**

Scale
1/48

Set contains highly detailed cockpit for British post-war carrier fighter aircraft. Set includes floor, seat and harness, side walls, bulkheads, instrument panel and control stick. Contains photo-etched parts.

GB, post WWII/Korean War

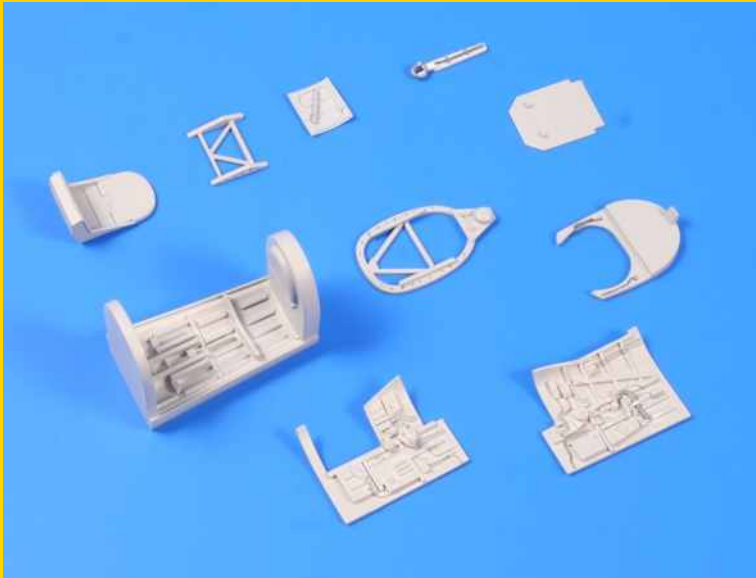

ITEM
8045

**Pz.Kpfw IV – Engine set
for Tamiya kit**

Scale
1/48

Set contains complete Maybach HL 120 TRM engine including all bulkheads and particular hatch for the legendary WW II Wehrmacht medium tank.

Germany, WWII

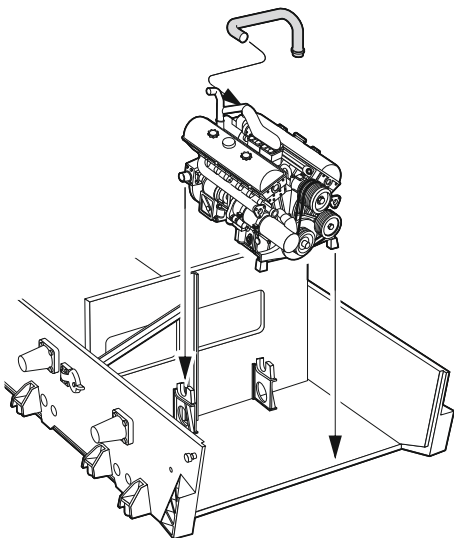

ITEM
7247

**Spitfire PR Mk XIX – Oil tank
for Airfix kit**

Scale
1/72

Set contains new oil tank with compartment located behind the engine including particular covers for high altitude reconnaissance version of British fighter from WW II and post war period.

GB, WWII / post WWII

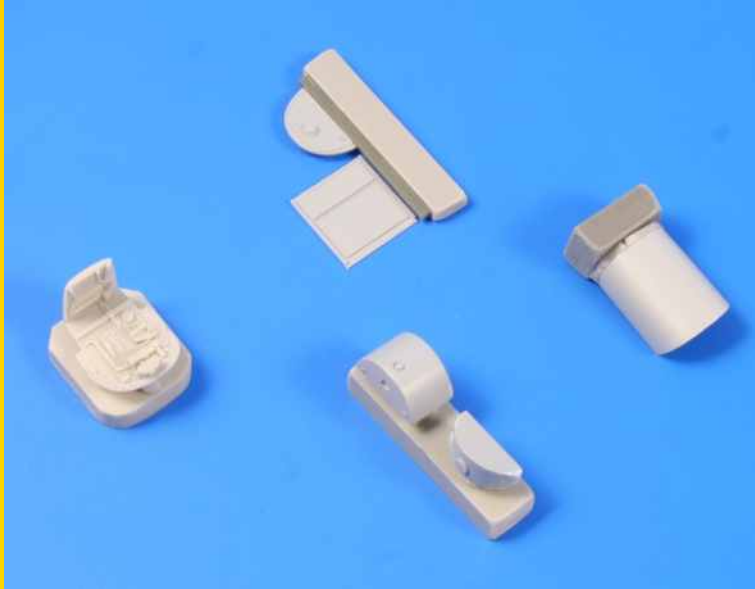

ITEM
7251

**Curtiss P-40E – Control surfaces set
for Academy kit**

Scale
1/72

Set contains new complete set of control surfaces (ailerons, landing flaps, rudder, horizontal stabilizer and elevators) for WW II US fighter aircraft. All the resin parts feature fine surface details (engraved panel lines and maintenance covers, sagged cloth) that the original kit lacks.

USA, WWII

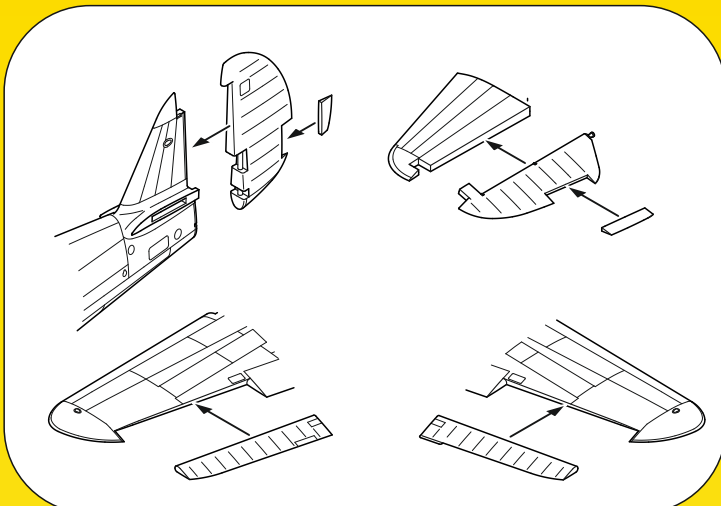

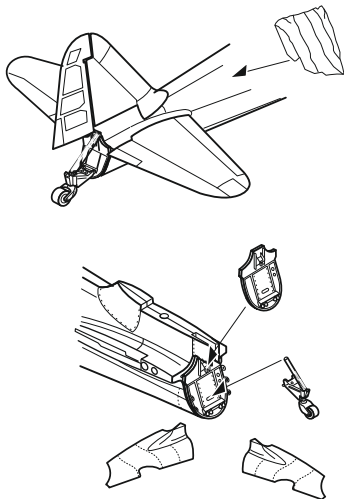

ITEM
7254

A6M2 model 21 Zero Armament set + Tail cone for Tamiya kit

Scale
1/72

Highly detailed resin set containing tail cone parts and wing armament bays for the most famous WWII Imperial Japanese Navy fighter. The set contains tail wheel and strut with its mount, last fuselage bulkhead and tail cone, wing armament bays, canons and particular covers.
Japan, WWII

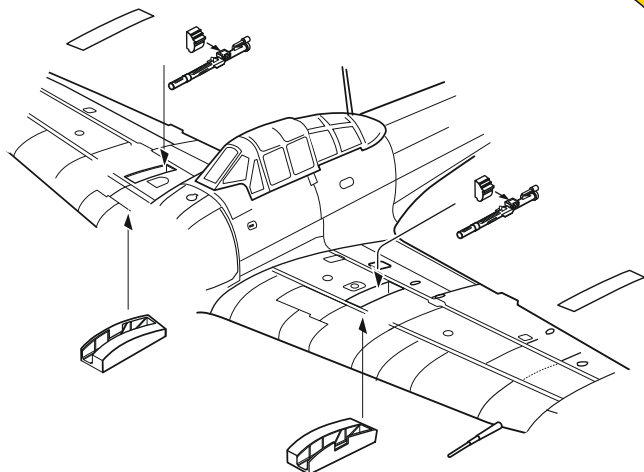

ITEM
MV 104

Tatra OA vz.30 – Full resin kit

Scale
1/72

MV104 OA vz.30

| | | | |
|-------|----|-------|----|
| 15376 | 1 | 15376 | 2 |
| 15384 | 3 | 15384 | 4 |
| 15392 | 5 | 15392 | 6 |
| 15390 | 7 | 15390 | 8 |
| 15326 | 9 | 15326 | 10 |
| 15377 | 11 | 15377 | 12 |

Highly detailed full resin kit of a 1930s Czechoslovakian armoured car. Tatra OA vz. 30s had been ordered in considerably large series and served in numbers in Czechoslovakian Army. Part of the vehicles was seized by Wehrmacht when Czechoslovakia was occupied by Germany. Wehrmacht deployed them for second line and police units. Rest of the vehicles had been assigned to Slovak State's Army and saw combat against Poland and Soviet Union. The kits is cast as single piece with separate mudguards, turret, wheels and axles and armament.

Czechoslovakia, pre WWII

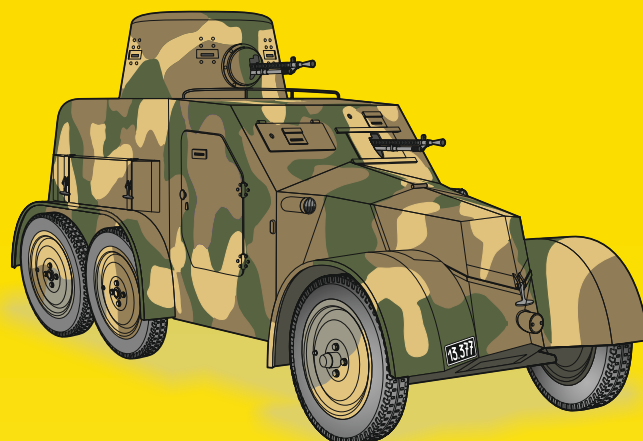

ITEM
MV 106

Orion V - Bundeswehr Container Load Trailer Full resin kit

Scale
1/72

Highly detailed full resin kit of a modern wheeled trailer loader used by Bundeswehr. Orion Vs are used in logistic centres in Germany and Afghanistan. The kit is cast as single piece with separate handling arm and telescopic struts that are positional. Decals included offer markings for two Bundeswehr machines.

Germany, Modern

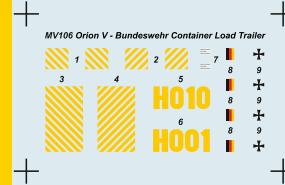
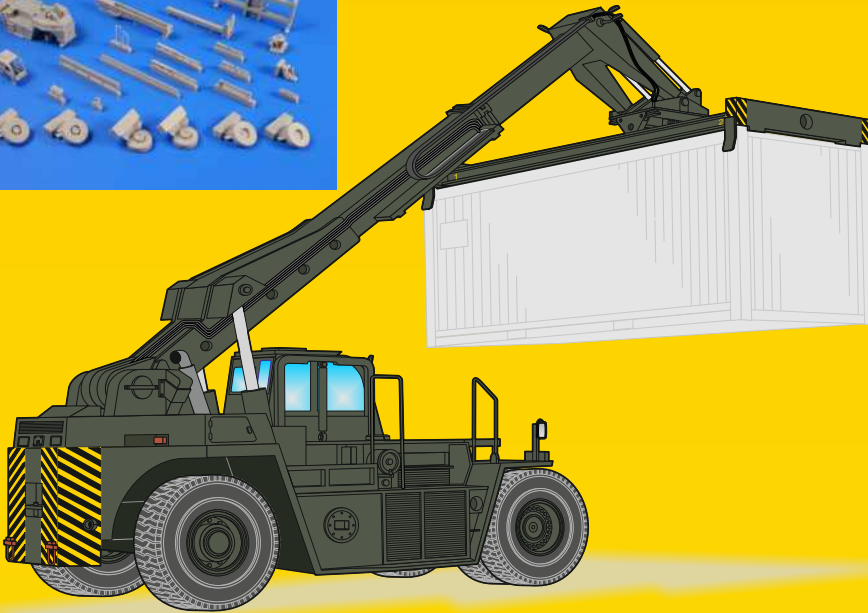

ITEM
MV 107

20 Feet Cargo Container – Full resin kit

Scale
1/72

Highly detailed full resin kit 20 feet cargo container. These containers are used all around the World for goods transport in both military and civil sectors. The container itself is cast hollow with separate floor and doors that can be attached in opened or closed position.

Modern

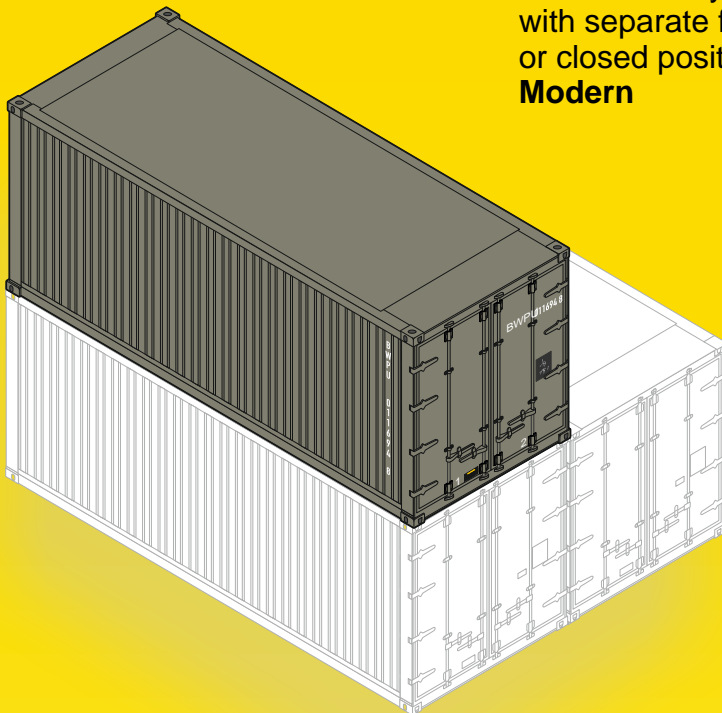

ITEM
Q32 182

**He 219A – Seat with harness
for Revell kit**

Scale
1/32

He 219 was the best WW II German night fighter and it was also one of the first aircraft of the World to be equipped with ejection seats. Since the new Revell kit features simplified seat we decided to recreate them with more details. The seats' include cast harness.

Germany, WWII

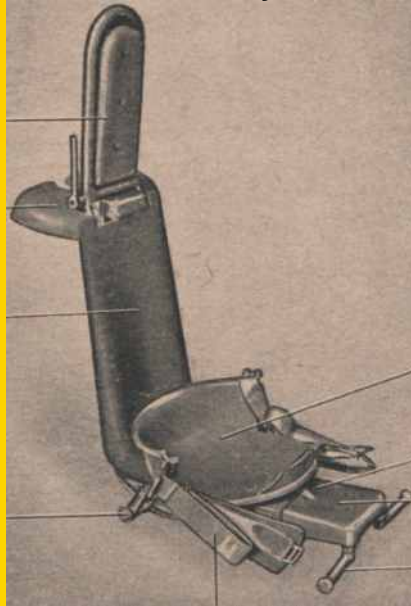
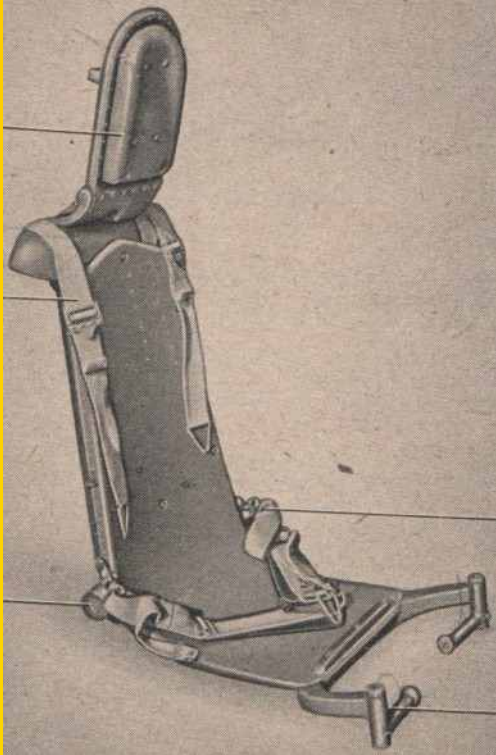

ITEM
Q48 178

**P-51D Mustang - Wheels
(Cross Tread Pattern)**

Scale
1/48

for Hasegawa / Revell / HobbyBoss / Tamiya kit

Set contains completely new main undercarriage wheels with Cross Tread Pattern. P-51D Mustang was one of the most successful and widespread Allied WW2 fighters.

USA, WWII



ITEM
Q48 179

**P-51D Mustang - Wheels
(Diamond Tread Pattern)
for Hasegawa/Revell/ HobbyBoss/Tamiya kit**

Scale
1/48

Set contains completely new main undercarriage wheels
with Diamond Tread Pattern.
USA, WWII

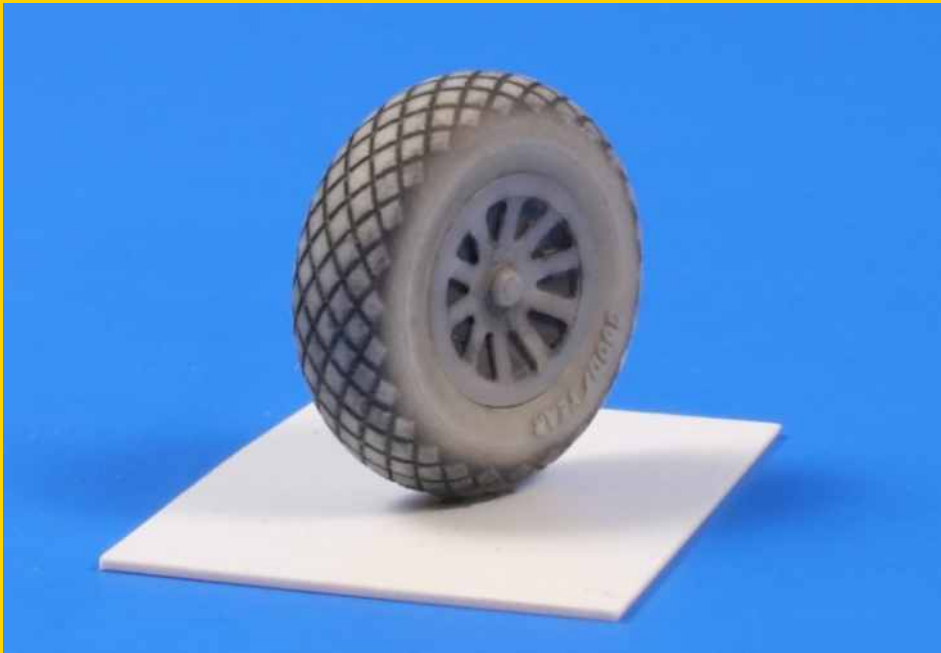

ITEM
Q48 180

**P-51D Mustang
- Wheels (Diamond and Hole Tread Pattern)
for Hasegawa/Revell/ HobbyBoss/Tamiya kit**

Scale
1/48

Set contains completely new main undercarriage wheels
with Diamond and Hole Tread Pattern.
USA, WWII

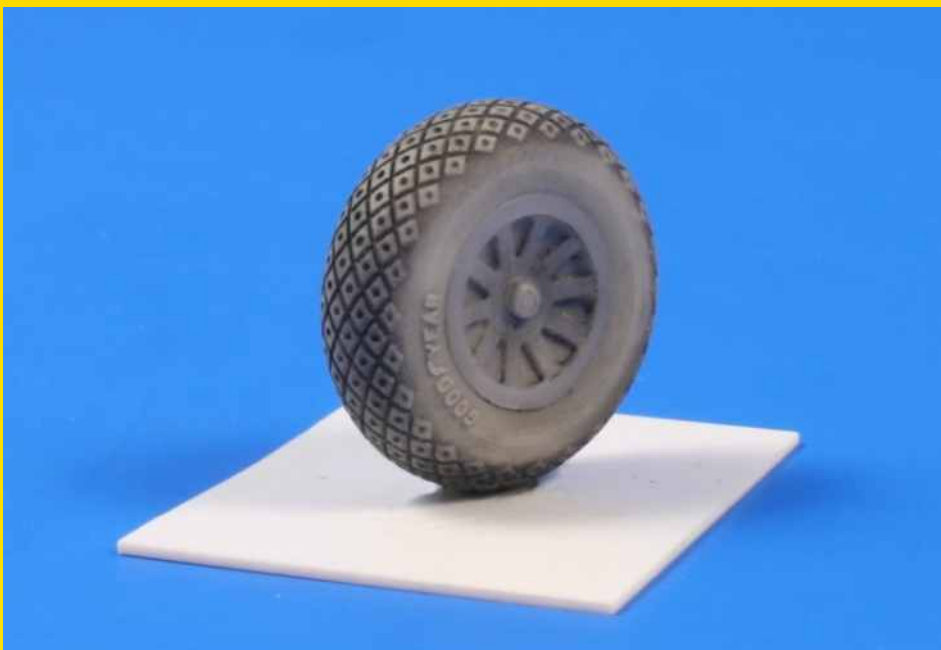

ITEM
Q48 181

P-51D Mustang
- Wheels (Oval Tread Pattern)
for Hasegawa/Revell/ HobbyBoss/Tamiya kit

Scale
1/48

Set contains completely new main undercarriage wheels with Oval Tread Pattern. These tires were used mainly in the ETO.
USA, WWII

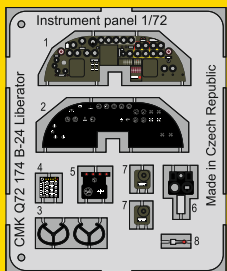
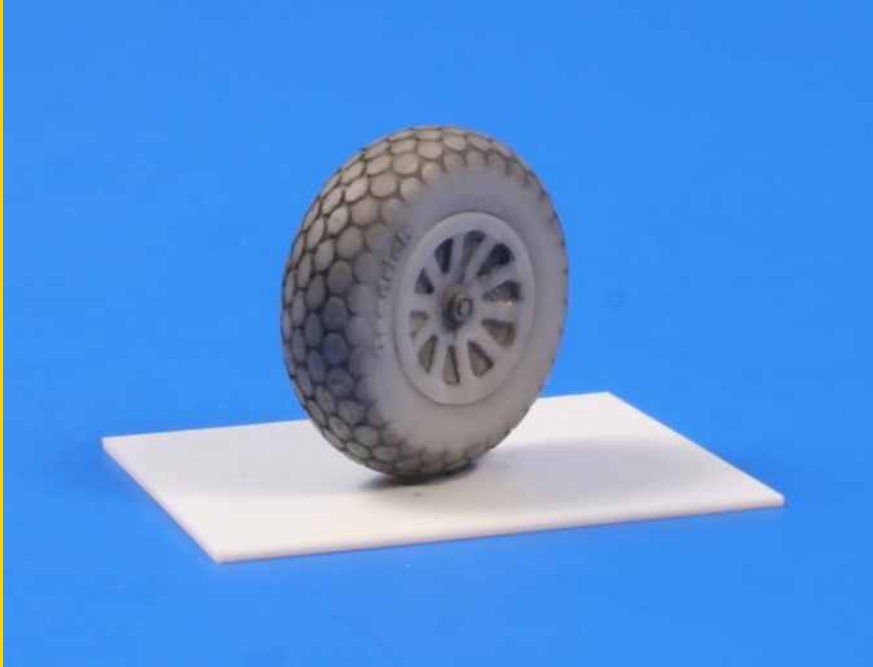

ITEM
Q72 174

B-24 Liberator
- Instrument panel for Hasegawa kit

Scale
1/72

Set contains detailed instrument panel for well known WW II US four-engined bomber. Set contains photo-etched parts.
USA, WWII

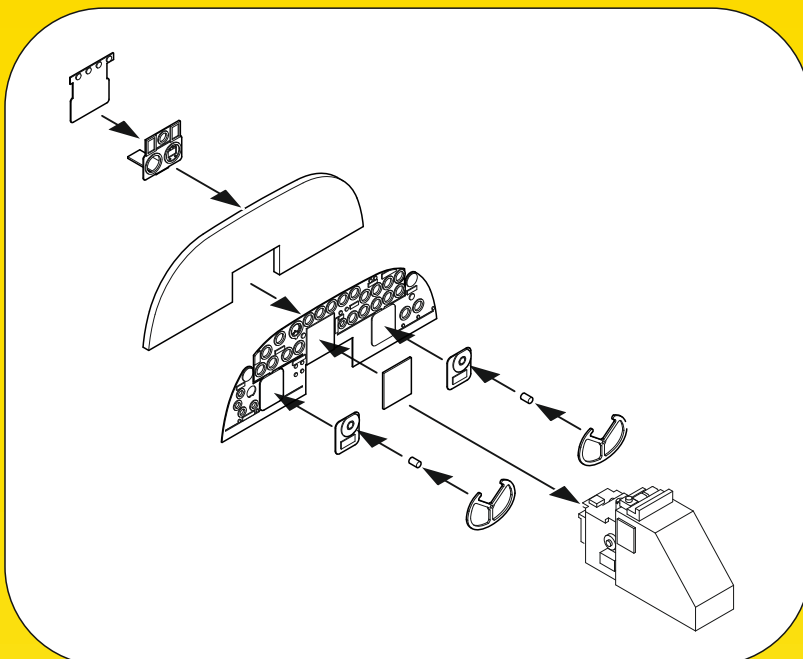

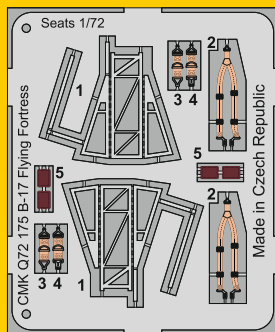

ITEM
Q72 175

B-17 Flying Fortress Seats for Revell/Hasegawa/Academy kit

Scale
1/72

Set contains detailed pilots' seats for the best known WW II US four-engined bomber. The seats' harness and frames are included in the colour photo-etched parts.
USA, WWII

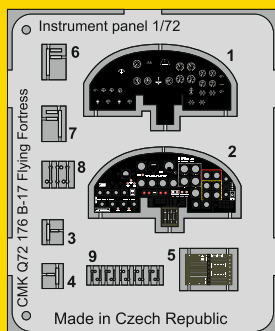
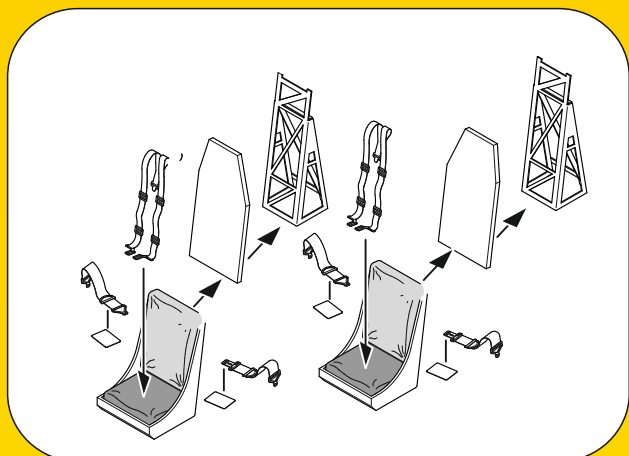

ITEM
Q72 176

B-17 Flying Fortress – Instrument panel for Revell/Has./Academy kit

Scale
1/72

Set contains detailed instrument panel for the famous B-17. Set contains resin and photo-etched parts.
USA, WWII

